

## Installing the mirror

- 1) Measure the centre distance between the mounting brackets. Mark the desired drill holes position for the wall plugs(①), and ensure the two hole marks are aligned horizontally.
- 2) Drill two holes into the wall at the marked location, and push in 2 wall plugs ensuring correct plugs for wall type are used. Drive 2 screws(②) into the wall plugs (①) and the screw head should be 3~4cm from the wall.
- 3) Attach the mirror via the brackets(③) onto the screws(②).

**Note: Before attaching the mirror, make sure the brackets(③) are above the position of the EVA sticker (④).**

- 4) Tear off the cover label of the EVA sticker(④) , stick the mirror to the wall to make it stable and without movement.

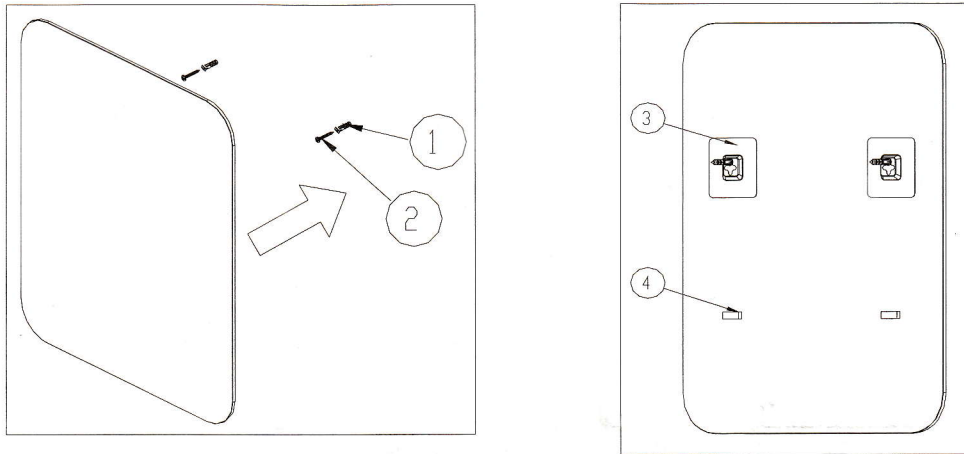

## Care & Use for all products available in Ovali Range

- Clean all surfaces using water and mild soap. Dry with a soft cloth. Never use rough sponges, abrasives or chemical cleaners.
- Do not place the glass shelf above a bath or in a shower enclosure.
- Do not place very hot or very cold items against or in close proximity to the glass.
- Do not strike the glass with hard or pointed items.
- Do not sit or stand on the glass.
- Do not attempt to cut the glass.
- The maximum safe load for glass shelf is 5 kg (Evenly distributed).
- If the glass shelf becomes chipped or broken ensure it is replaced with the correct toughened glass, see technical details below.

## Technical information

- The glass shelf is tempered to conform to BS6206, ensure any replacement glass is tempered to conform to this standard.
-